

Enrichment

Student Edition
Pages 346-353**Scale Drawings**

Scale drawings are helpful for planning furniture arrangements. The shapes in the drawing below are similar to the bases of the actual objects, but smaller in size. In the drawing, the scale is $\frac{1}{4}$ inch = 1 foot, and the side of each small square is $\frac{1}{4}$ inch.

Example: What are the dimensions of the bed in inches?

$$3\frac{1}{2} \times 12 = 42$$

$$6\frac{1}{2} \times 12 = 78$$

The bed is about 42 inches wide and 78 inches long.

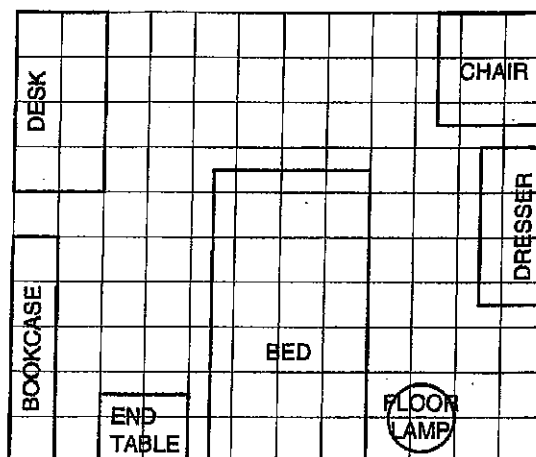

Use the scale drawing above to find the approximate size of each object.

1. size of room in feet
2. length and width of bookcase in feet
3. length and width of dresser in inches
4. length and width of end table in inches
5. length and width of chair in inches
6. diameter of the floor lamp in inches

Show each object on the grid at the right. Use the scale $\frac{1}{4}$ in. = 1 ft.

7. sofa, 72 in. by 36 in.
8. coffee table, 24 in. by 48 in.
9. chair, 24 in. by 30 in.
10. cabinet, 36 in. by 18 in.
11. television, 24 in. by 18 in.
12. On separate paper, make a scale drawing of a bedroom or living room of your home. Show the furniture.

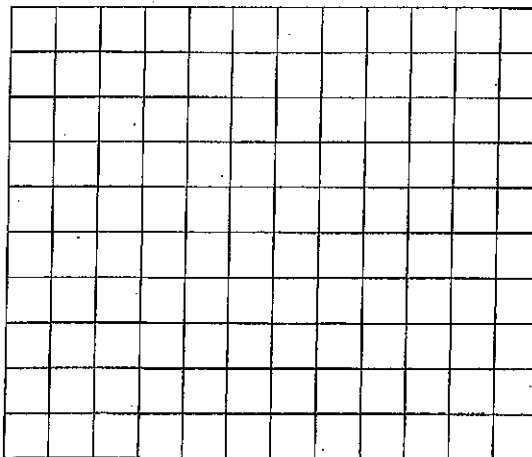

Name _____

Date _____ Block _____

SCALING PRACTICE

- Use the space to the right to SHOW YOUR WORK.

For #1-6, use the scale $\frac{3}{4}$ inch = 1 foot

1. 12 feet = _____ inches
2. 8 feet = _____ inches
3. 10 feet = _____ inches
4. _____ feet = 3 inches
5. _____ feet = 5 inches
6. _____ feet = 10.5 inches

For #7-12, use the scale $\frac{1}{2}$ inch = 1 foot

7. 12 feet = _____ inches
8. 8 feet = _____ inches
9. 13 feet = _____ inches
10. _____ feet = 3 inches
11. _____ feet = 5 inches
12. _____ feet = 7.25 inches

For #13-18, use the scale $\frac{1}{4}$ inch = 3 foot

13. 12 feet = _____ inches
14. 9 feet = _____ inches
15. 20 feet = _____ inches
16. _____ feet = 3 inches
17. _____ feet = 5 inches
18. _____ feet = 8.25 inches

For #19-24, use the scale $\frac{2}{3}$ inch = 1 foot

19. 12 feet = _____ inches
20. 8 feet = _____ inches
21. 22 feet = _____ inches
22. _____ feet = 3 inches
23. _____ feet = 5 inches
24. _____ feet = 9 inches